

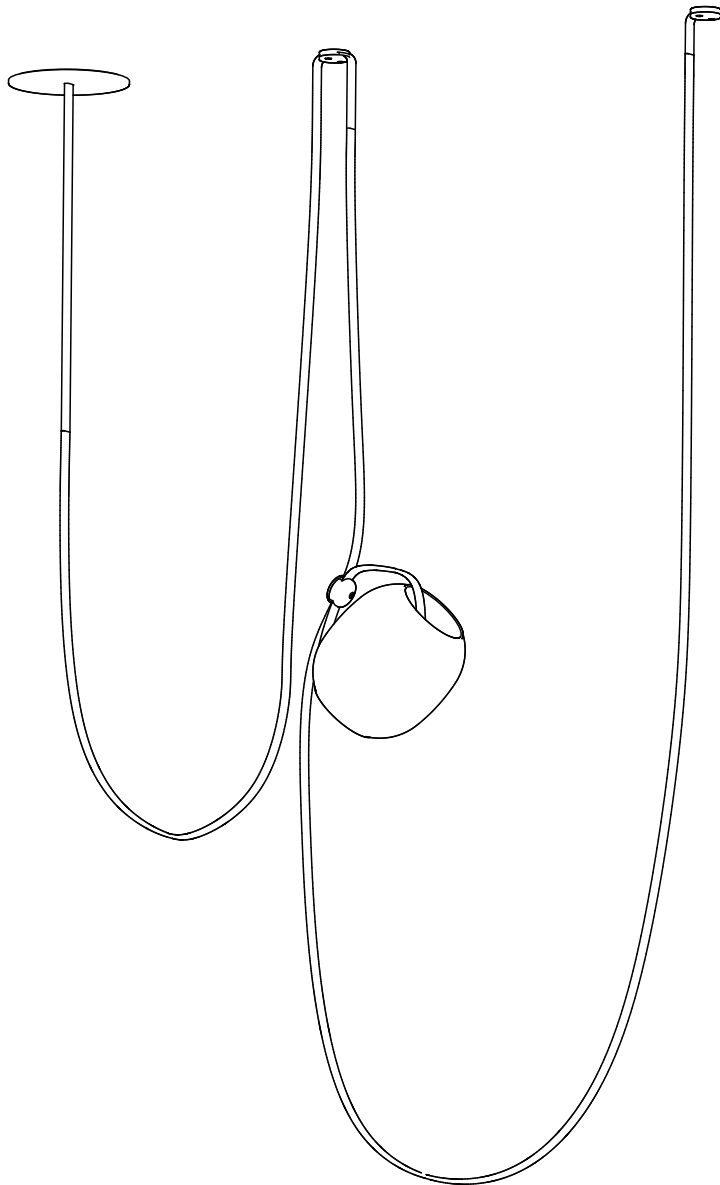

Vitis 1

13087 rD



CAUTION:

Before starting, turn off power at main circuit panel.

ADVERTENCIA:

Antes de comenzar la instalación, apague la corriente en el tablero principal.

ATTENTION:

Coupez l'alimentation avant de procéder à l'installation.



Calling for backup? Scan above to contact our team.

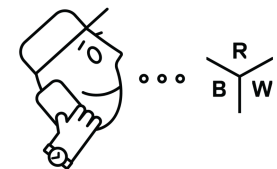
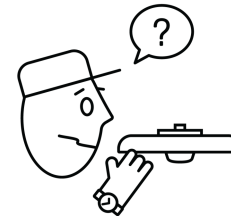

www.RBW.com
+1 212 388 0399
support@RBW.com
© 2023, RBW Studio LLC

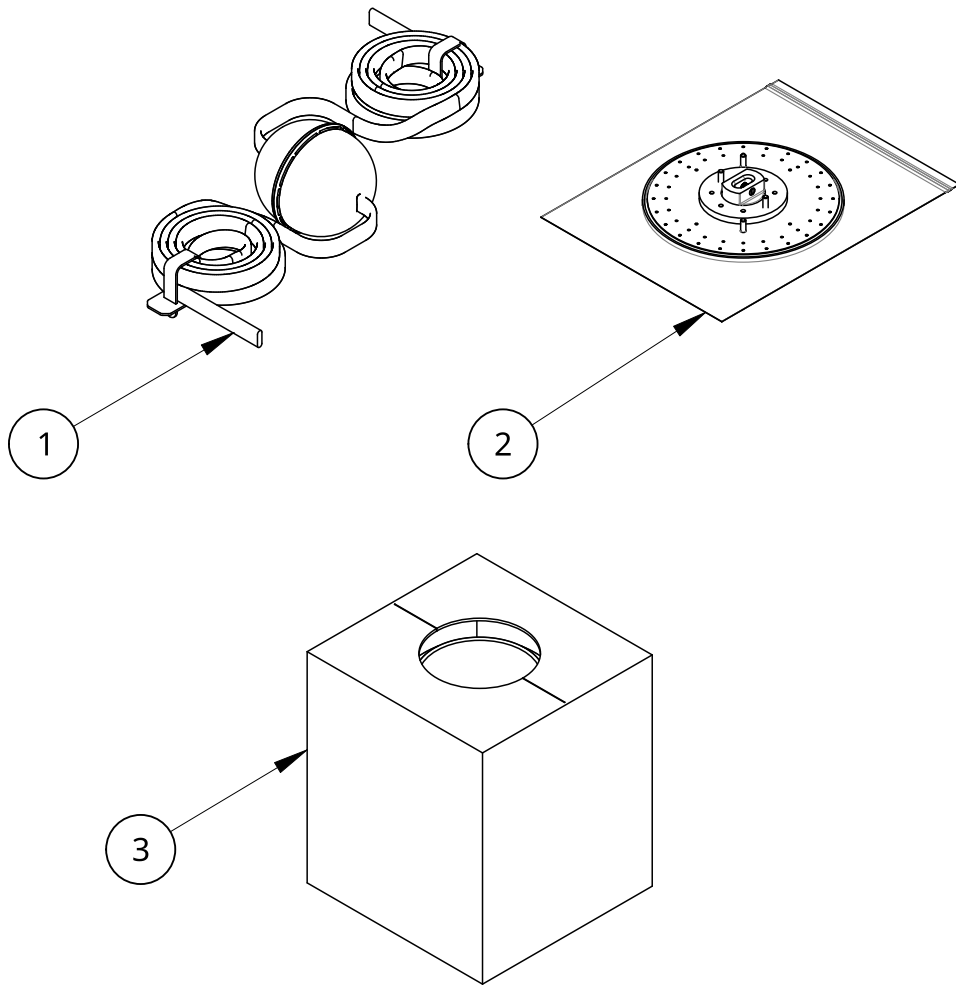

Item	Qty	Description
1	1	Package: Vitis 1 Assembly
2	1	Package: Vitis 1 Canopy Kit
3	1	Vitis Glass Box

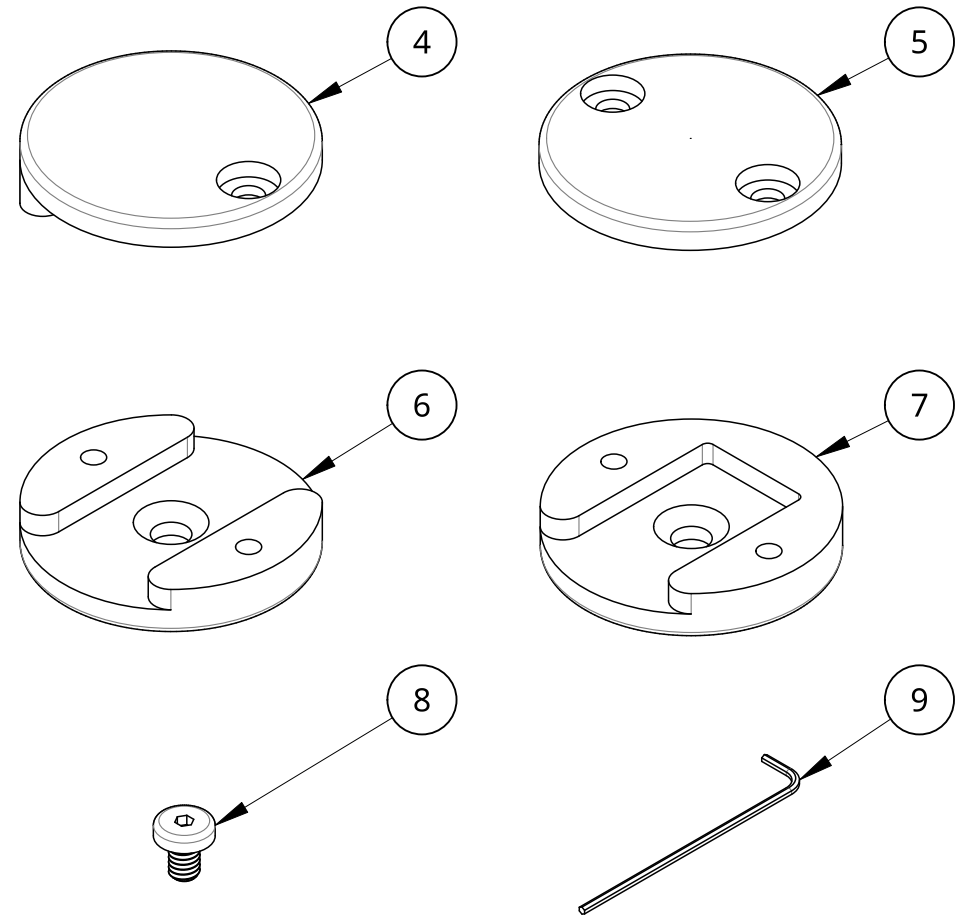

Vitis 1 Cord Grip Components

Item	Qty	Description
4	2	Vitis Cord Grip
5	2	Vitis Cord Grip Ceiling Cover
6	1	Vitis Cord Grip Ceiling
7	1	Vitis Cord Grip End
8	6	Vitis Hex Screw
9	1	Hex L-Key, 5/64" x 3-3/8" L

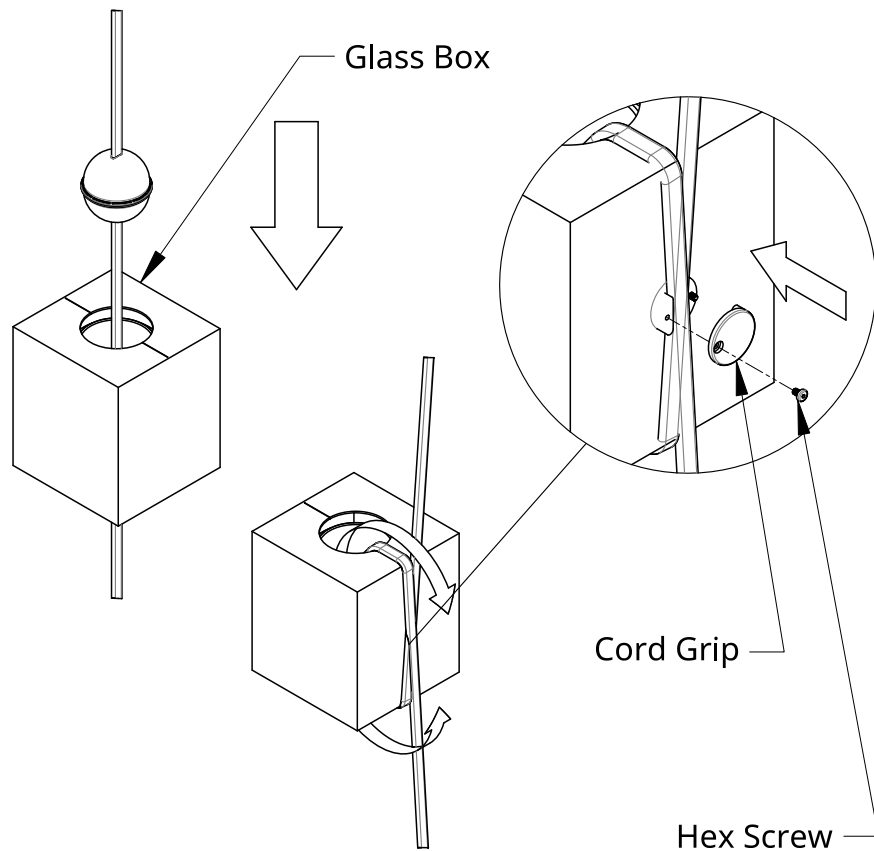

Installation - Glass Assembly in Box

1. Remove perforated circles from Glass Box. Leave perforated strip at this time. Poke hole in plastic bag.
2. Starting from one end, feed Power Cord through Glass Assembly in Box until Glass is centered over Module Assembly.
3. Fold Power Cord sections over edge of Glass Box on perforated strip side and overlap Cords.
4. Use 2 Cord Grip (Item 4) parts and 2 Hex Screws (Item 8) to secure overlapping Cords.
5. Before fully securing Cord Grips, pull Power Cords tight to the Glass Box.

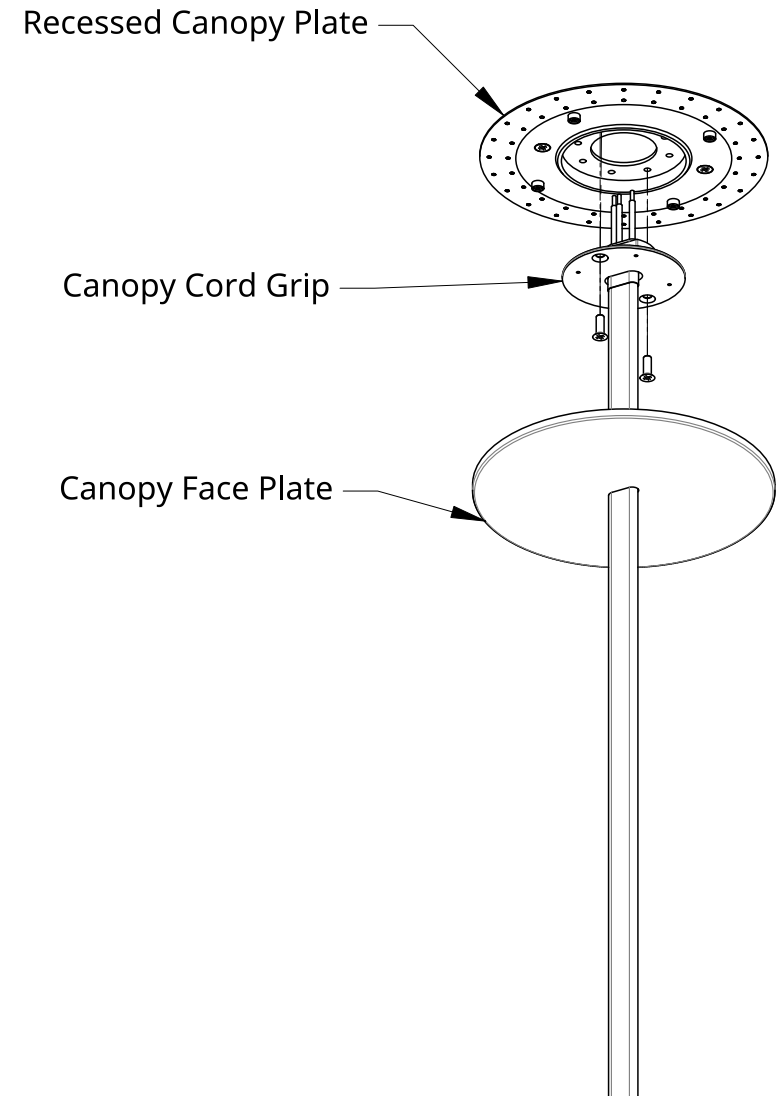

Installation - Canopy

1. Refer to Canopy Instructions Sheet 13092.

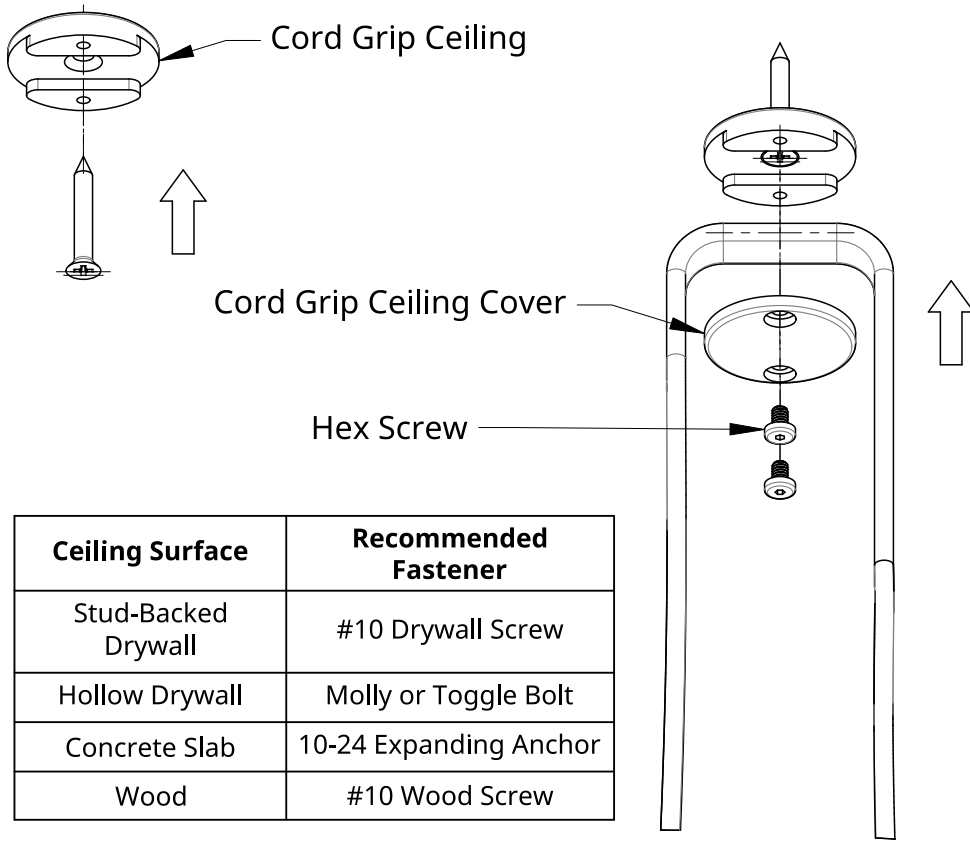

Installation - Cord Grips

1. Start by marking all hang points on ceiling corresponding to desired configuration.
2. Using an appropriate fastener loosely secure all Cord Grip Ceiling parts (Item 6) and Cord Grip End (Item 7) in place, allowing freedom to rotate parts as needed.
3. Secure Cord Grips to ceiling in desired orientations. (may be subject to changes for desired outcome)
4. Starting with first Cord Grip, place product Cord in Cord Grip channel and place Cord Grip Ceiling Cover (Item 5) on top.
5. Using 2 Hex Screws (Item 8), fasten the two Cord Grip pieces together to secure Cord. (Can be left loose until end of install to make adjustments)

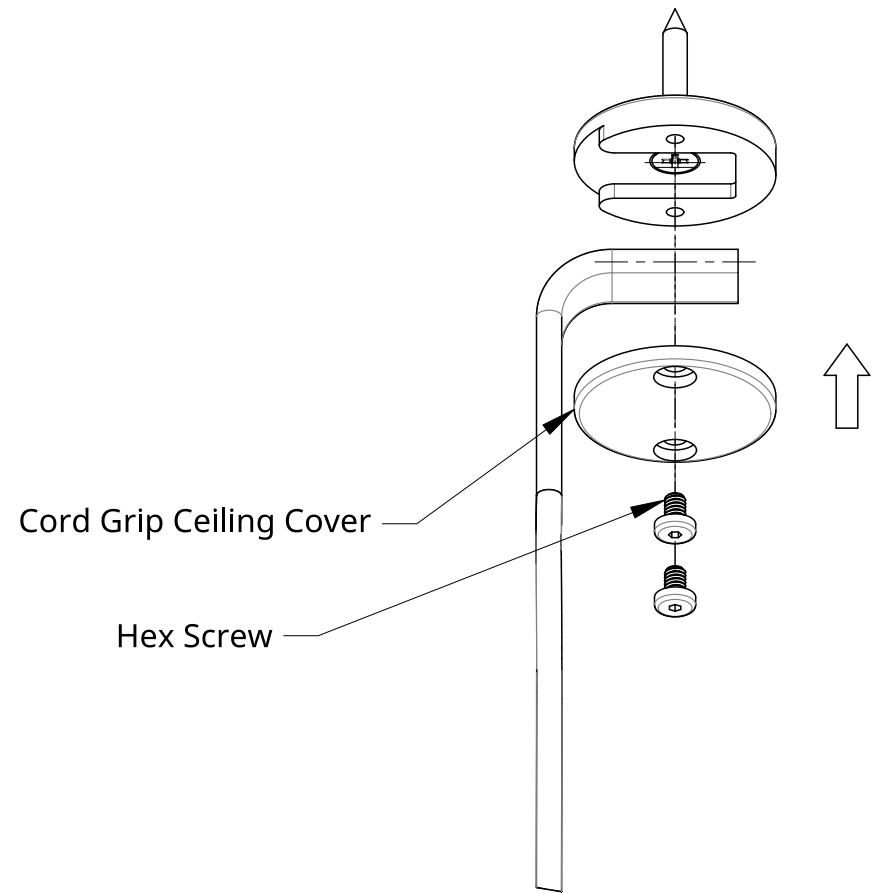

Installation - Cord Grip End

6. Repeat previous Cord Grip steps.
7. Once fixture is adjusted, tighten all Hex Screws to fully secure Cords.
8. Congratulations! End of guide.

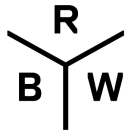

Vitis Canopy

13092 rD

Low Voltage

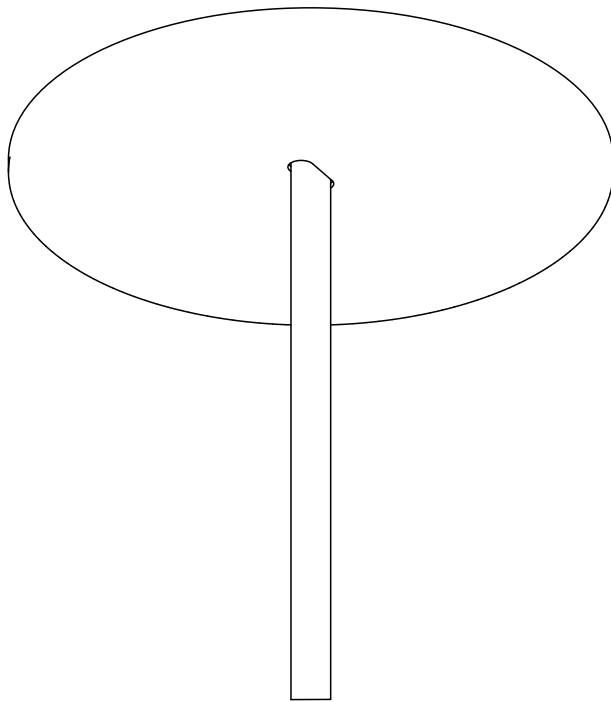

CAUTION:

Before starting, turn off power at main circuit panel.

ADVERTENCIA:

Antes de comenzar la instalación, apague la corriente en el tablero principal.

ATTENTION:

Coupez l'alimentation avant de proceder à l'installation.



Calling for backup? Scan above to contact our team.

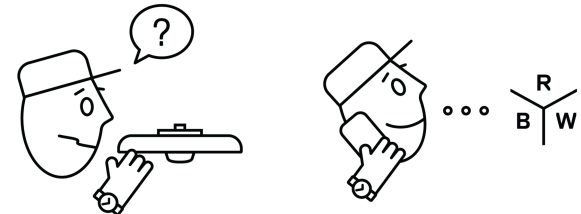

www.RBW.com
+1 212 388 0399
support@RBW.com
© 2023, RBW Studio LLC

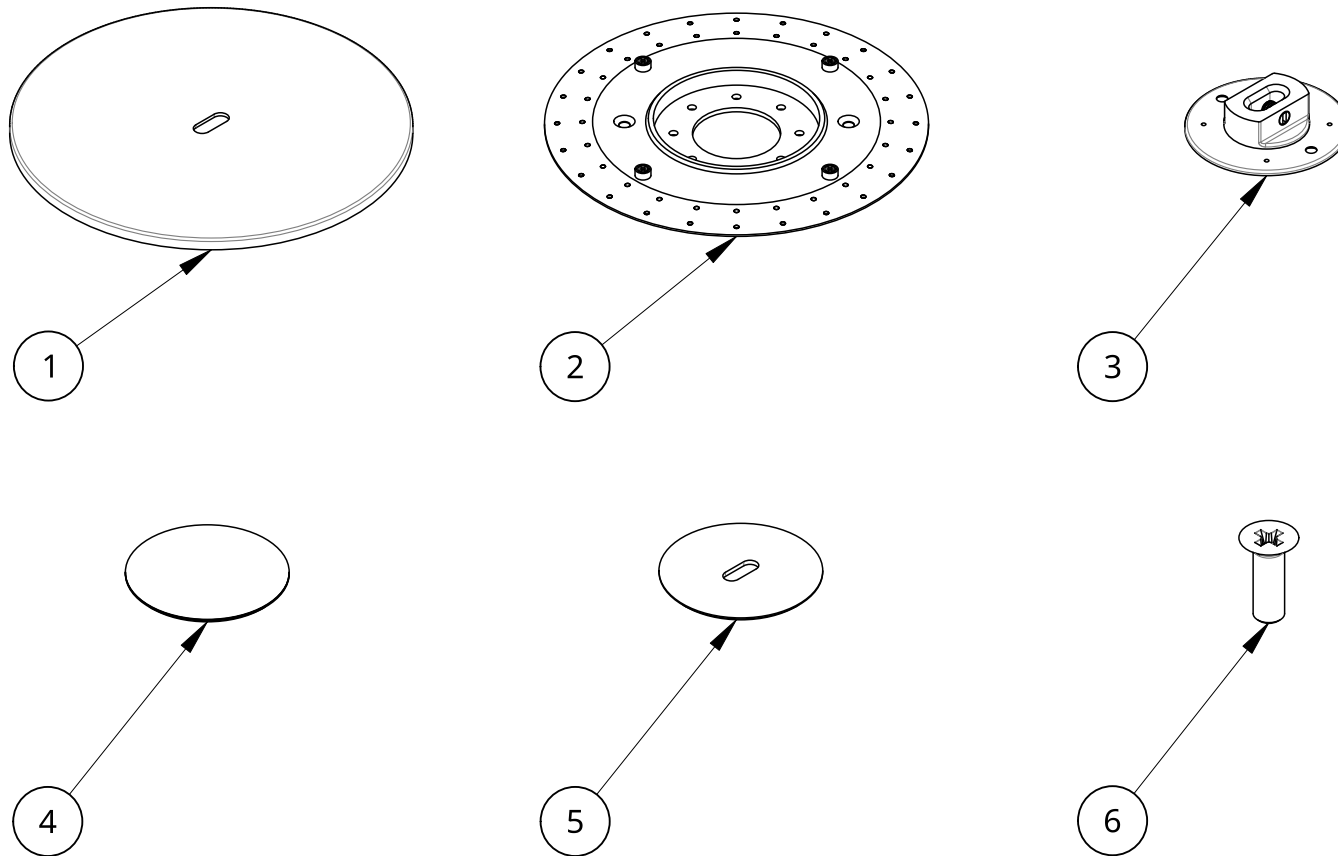

Item	Qty	Description
1	1	Vitis Canopy Face Plate
2	1	Recessed Canopy Plate with Magnets
3	1	Vitis Canopy Cord Grip with Set Screw
4	1	Recessed Hole Cover with Puncture Sticker
5	1	Recessed Canopy Cover
6	4	Flat Head (100) machine screw #8-32 x 0.5" Steel

Recessed Canopy Instructions

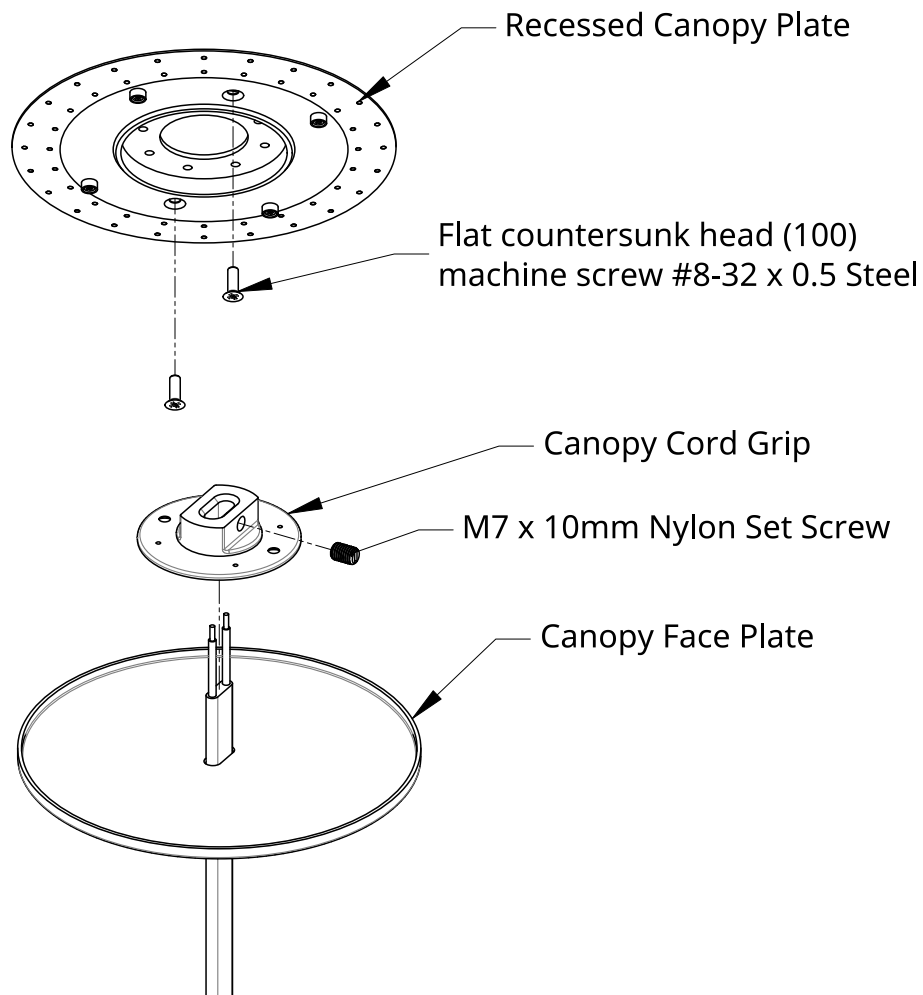

Installation - Recessed Canopy Plate & Cord Grip

1. Raise Recessed Canopy Plate up to desired mounting location.
2. Secure with two #8-32 Flat head screws.
3. Slide Canopy Face Plate over Power Cord.
4. Secure Power Cord in Canopy Cord Grip with Nylon Set Screw. (Leave enough wire to make electrical connections)

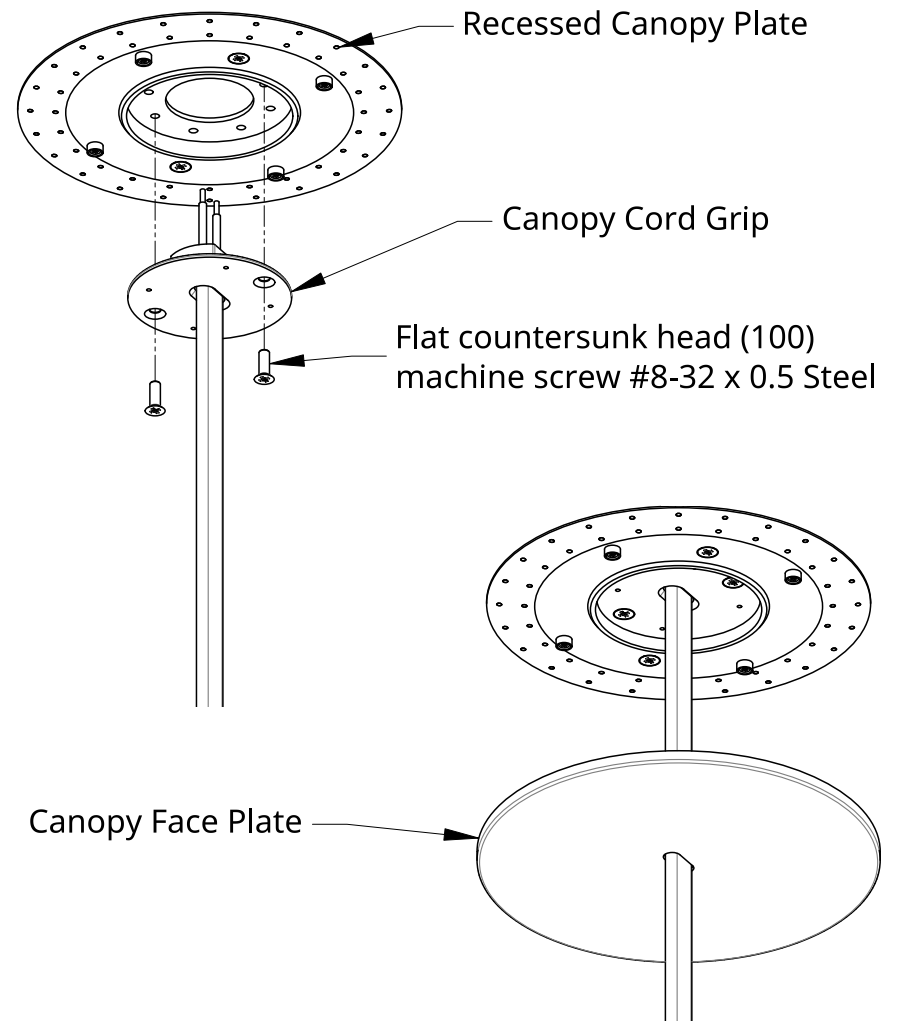

Installation - Canopy Face Plate

5. Connect Copper Stranded Lead (+) and Silver Stranded Lead (-) to low voltage leads from externally located driver.
6. Raise Canopy Cord Grip to Recessed Canopy Plate and secure with #8-32 Flat head screws.
7. Raise Canopy Face Plate to Recessed Canopy Plate so magnets secure the Face Plate.

Mud-In Canopy Instructions

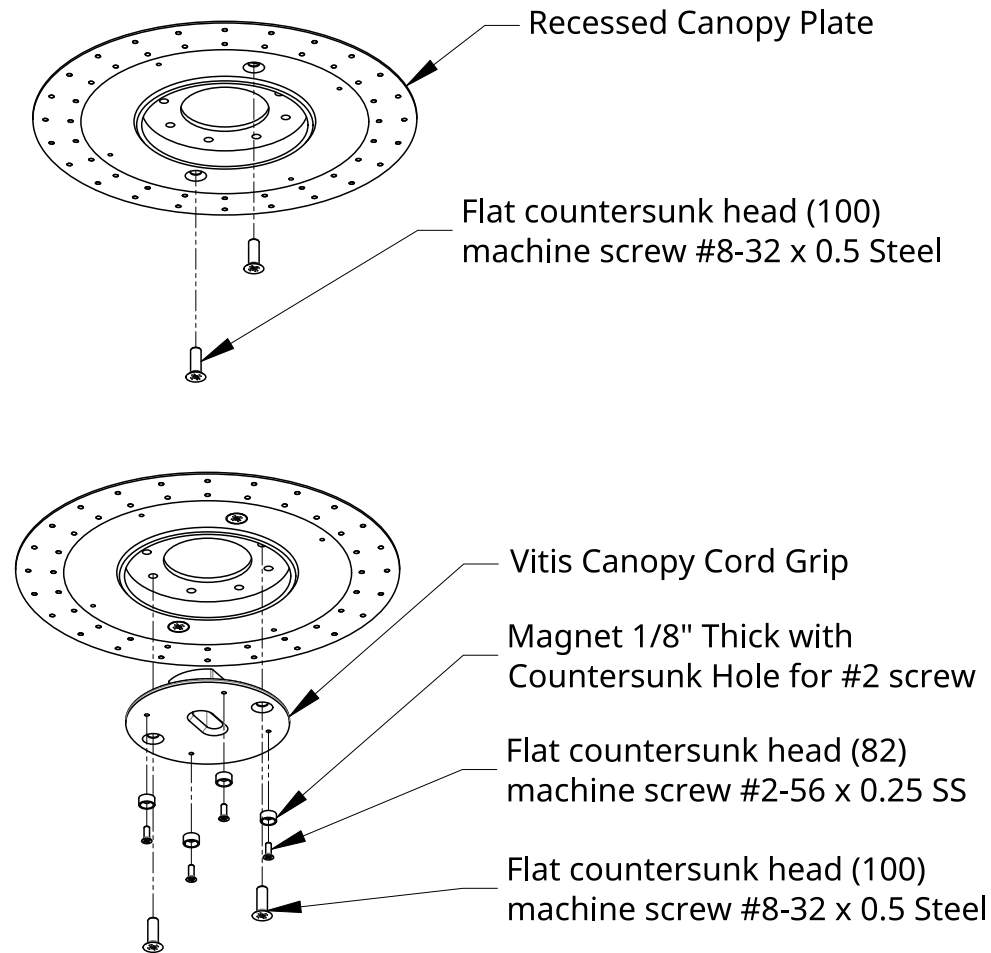

Installation - Recessed Canopy Plate & Cord Grip

1. Start by removing Magnets and #2-56 Flat head Screws from their pre-installed location.
2. Raise Recessed Canopy Plate up to desired mounting location.
3. Secure with two #8-32 Flat head screws.
4. Fasten #2 Magnets to Cord Grip with #2-56 Flat head Screws.
5. Secure Cord Grip to Recessed Canopy Plate with #8-32 Flat Head Screws.

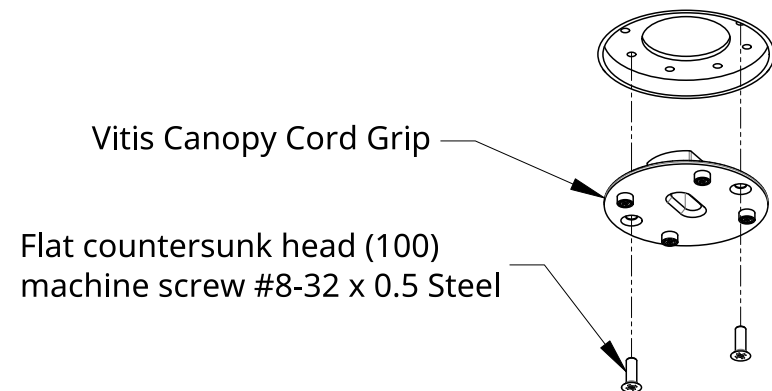
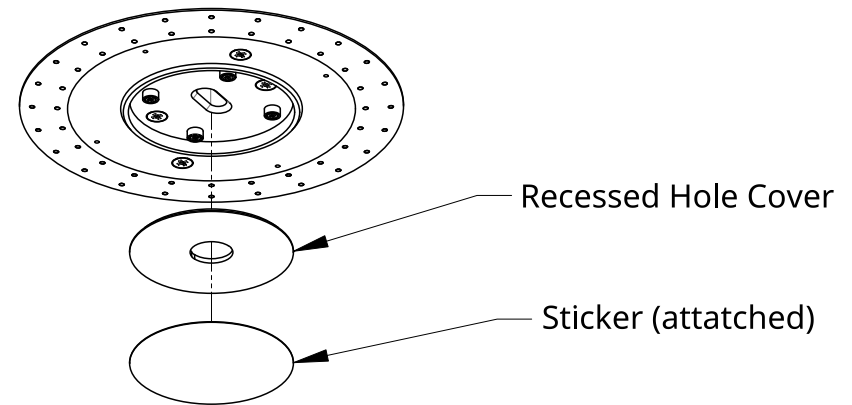

Installation - Hole Cover

6. Raise Hole Cover to Recessed Canopy Plate so magnets secure the Hole Cover.
7. Apply Spackle to cover Recessed Canopy Plate.
8. Once Spackle is dried, sanded smooth and painted, puncture center of Sticker to remove Hole Cover.
9. Remove #8-32 Screws to remove Cord Grip assembly.

Mud-In Canopy Instructions

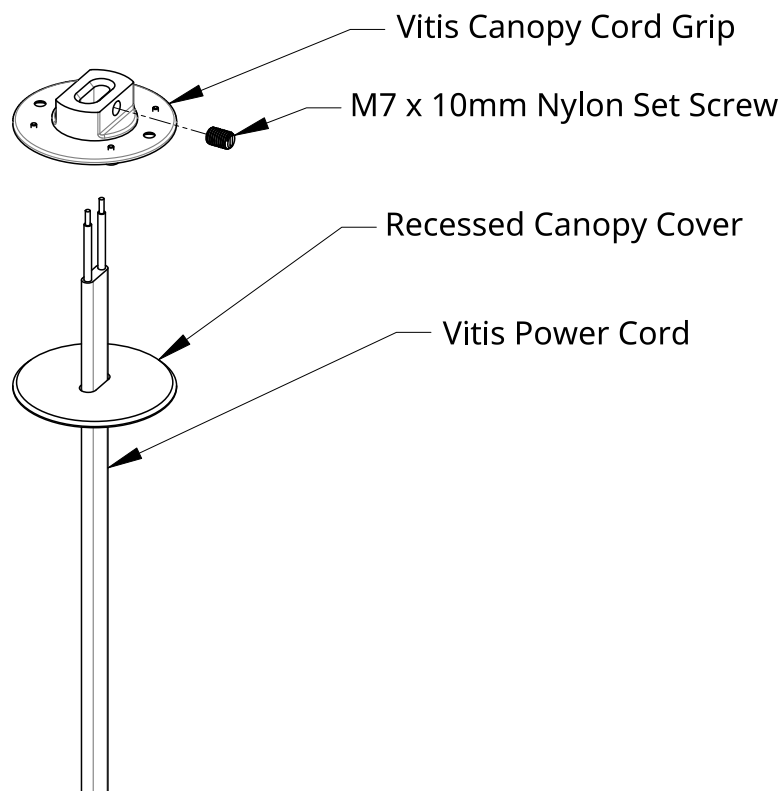

Installation - Cord Grip

1. Slide Canopy Cover over Vitis Power Cord.
2. Secure Power Cord in Canopy Cord Grip assembly with Nylon Set Screw.

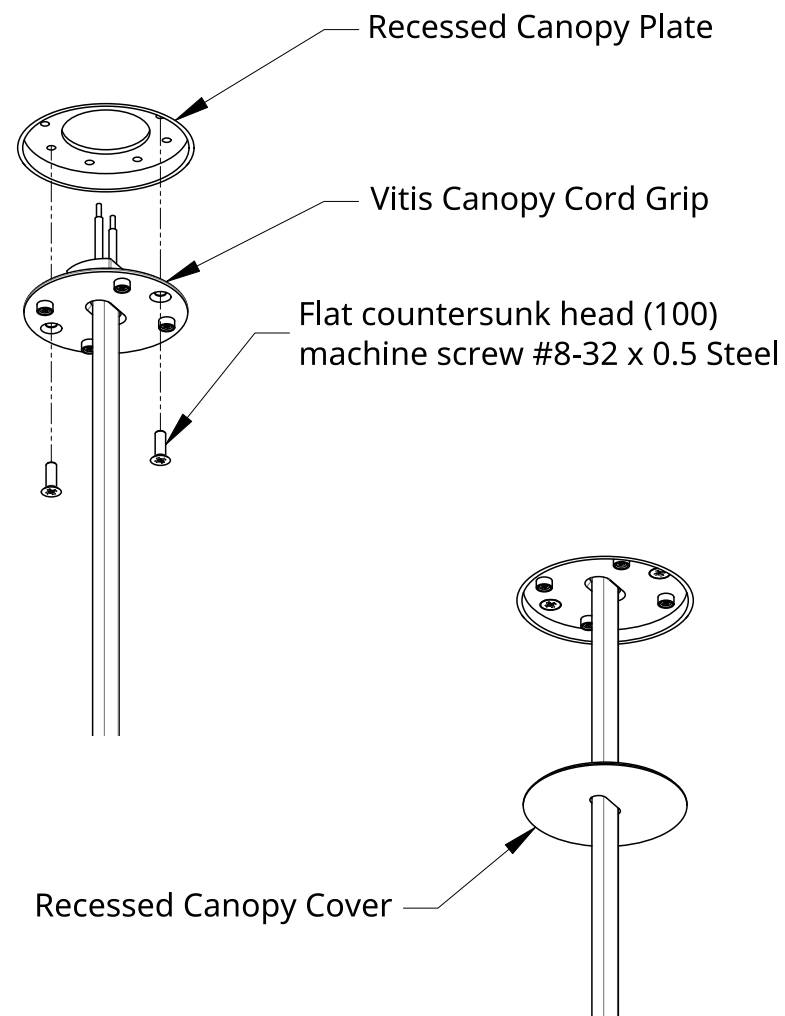

Installation - Canopy Face Plate

3. Connect Copper Stranded Lead (+) and Silver Stranded Lead (-) to corresponding low voltage leads from externally located driver.
4. Raise Canopy Cord Grip assembly to Recessed Canopy Plate and secure with #8-32 Flat head Screws.
5. Raise Canopy Cover to Recessed Canopy Plate so magnets secure the Canopy Cover.
6. Congratulations! End of guide.